



Problems we are facing on Earth for sustainable living are similar to those we will face on Mars for life support



The transition to regenerative environmental solutions on Earth **is a necessity for the future of human civilization on our planet.**



Testing regenerative life support solutions on Earth first **is a prerequisite for the future of human civilization on other planets.**



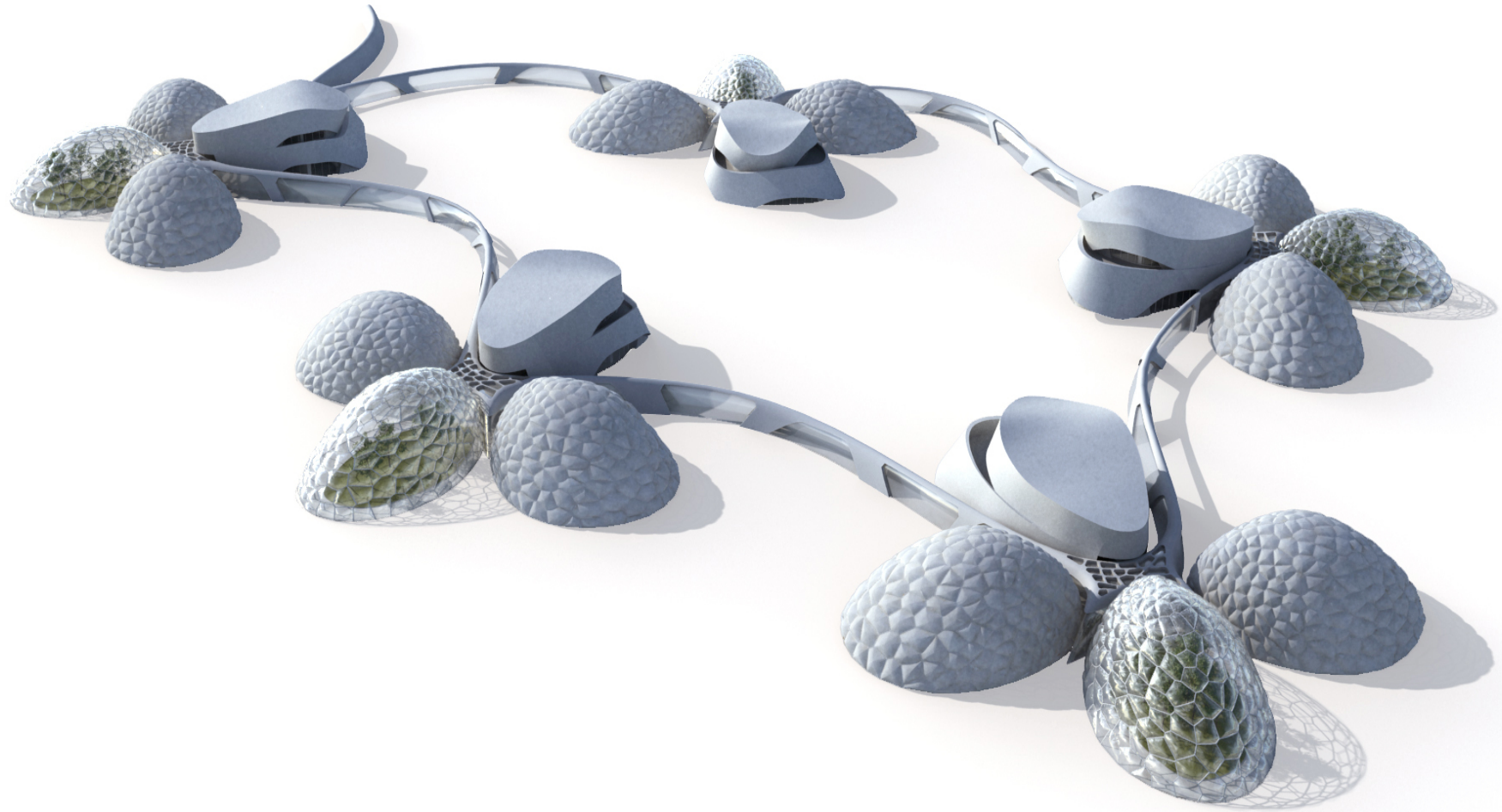



HABITAT

AEROPONICS

WATER & WASTE SYSTEM

GREENHOUSE

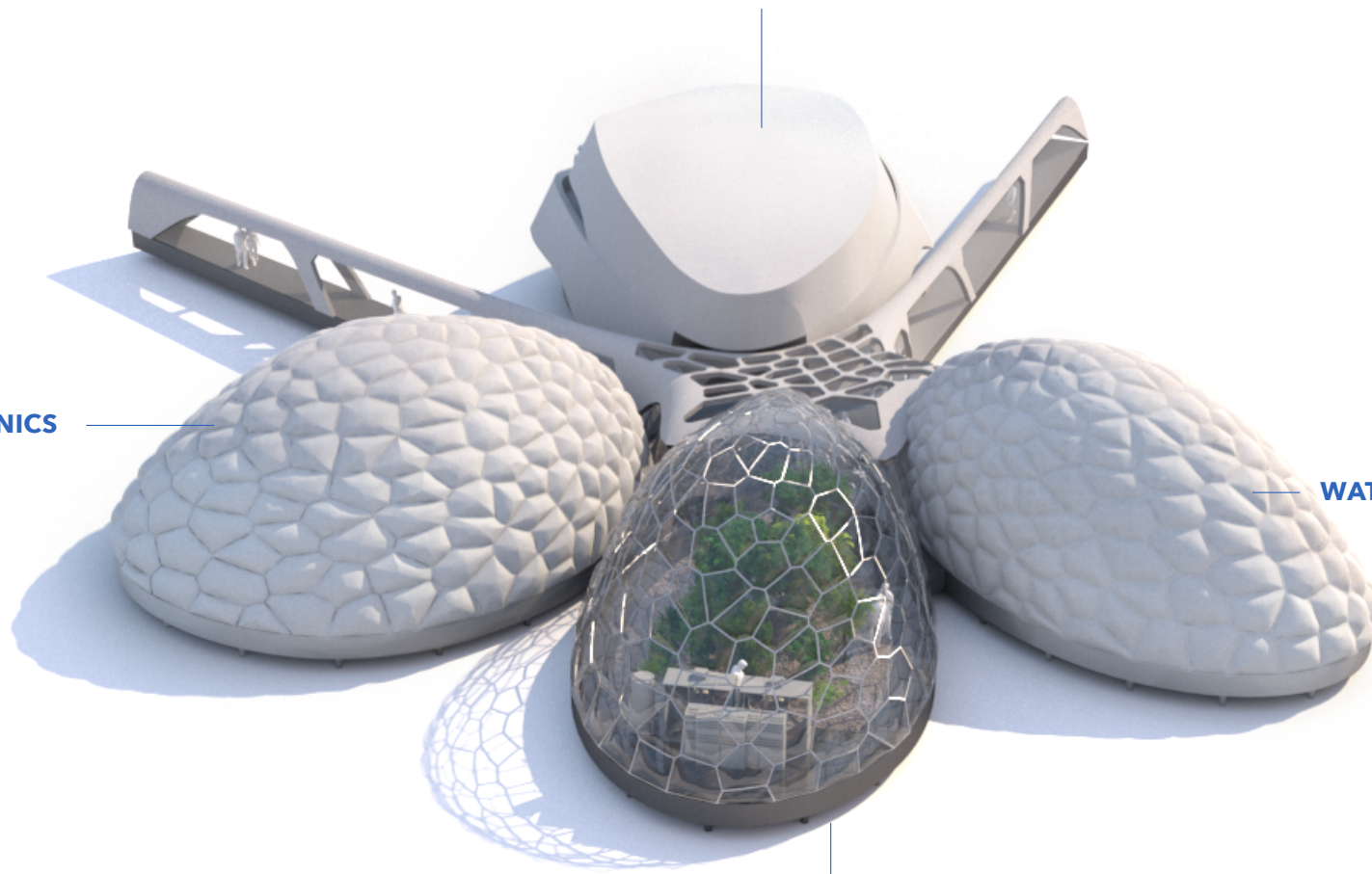

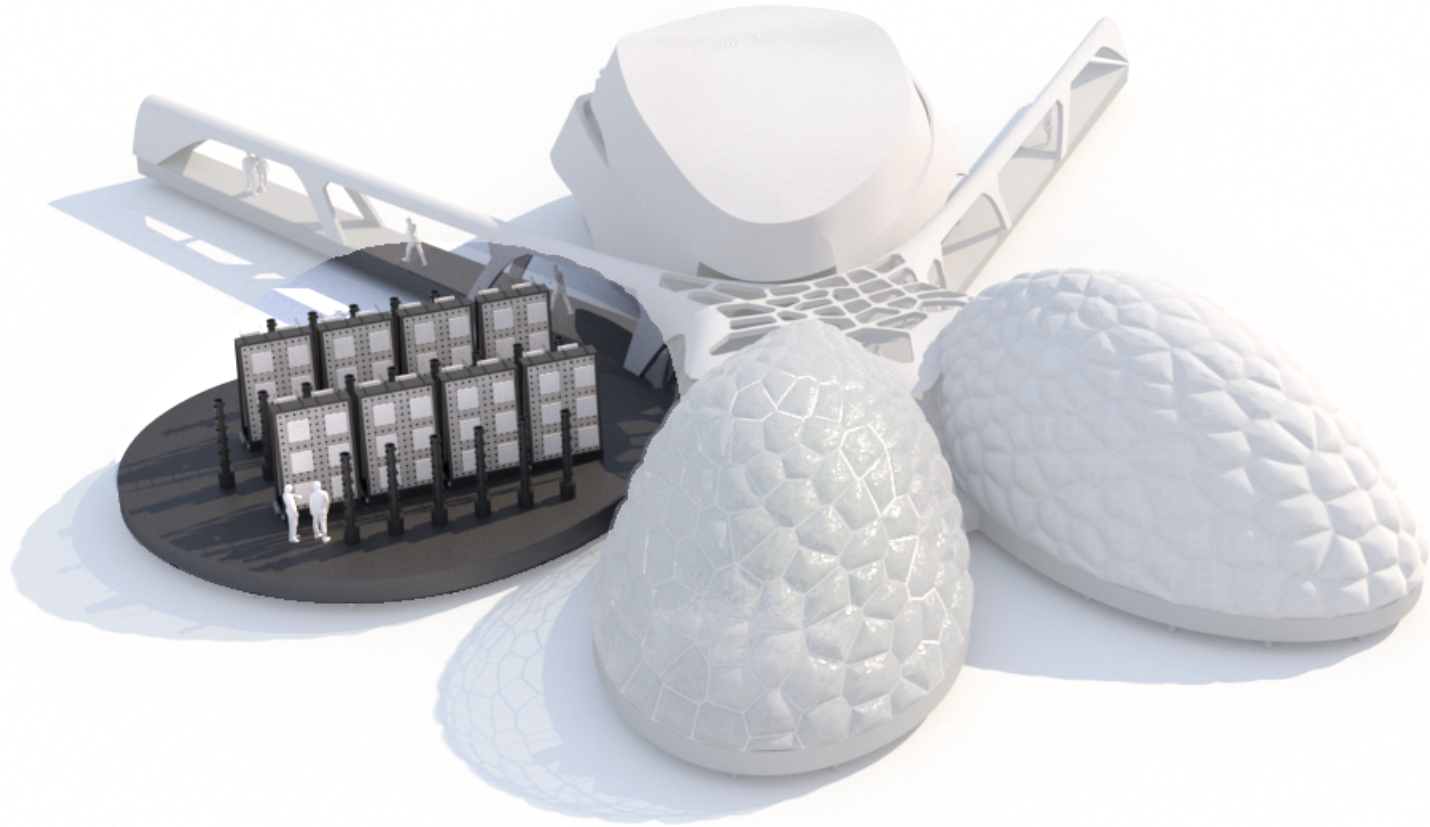

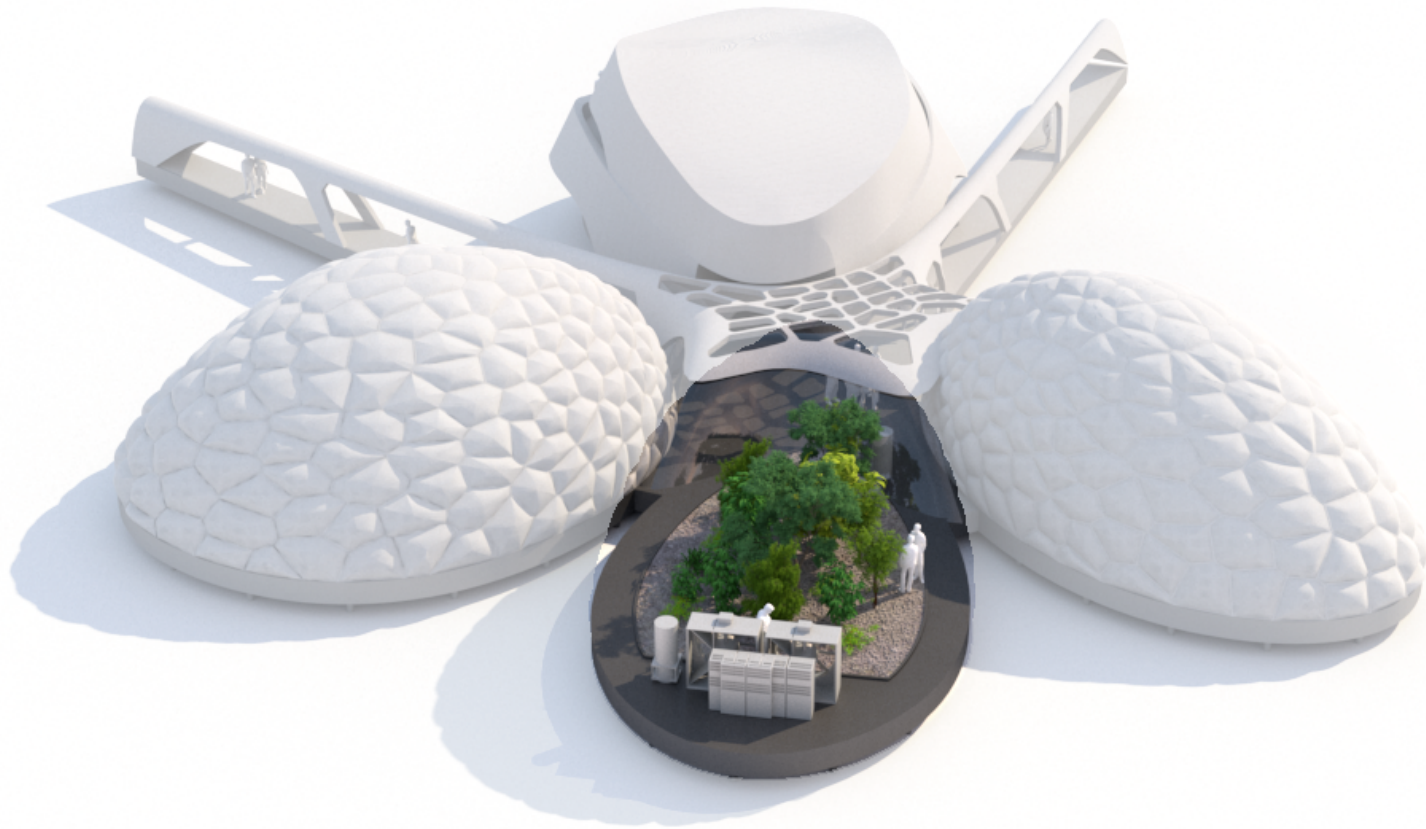

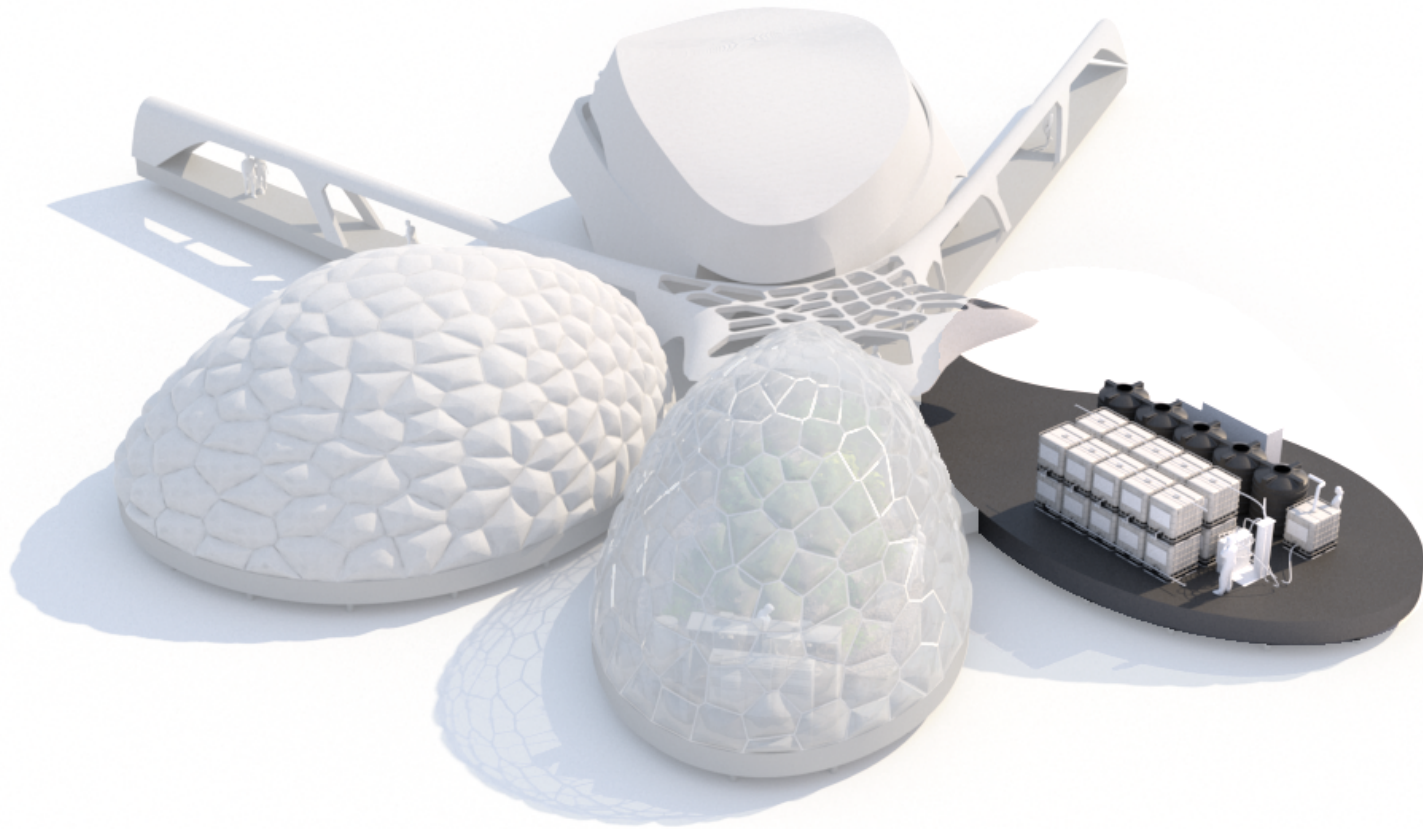



entirely monitored thanks our prediction software

The image displays three screenshots of the EBios Simulator interface. The top-left screenshot is the login screen with the Interstellar Lab logo and the text "WELCOME TO EBIOS SIMULATOR" and "CONFIGURE YOUR MISSION REQUIREMENTS TO SIMULATE AND BUILD YOUR OWN EBIOS STATION". The top-right screenshot is the "DASHBOARD" showing "REAL TIME" and "PREDICTION" data for various systems: EXTERIOR CONDITIONS, GREENHOUSE, AEROPONICS SYSTEM, HABITAT, WASTE MANAGEMENT, and WETLAND. The bottom-left screenshot is the "RESULTS" screen showing "GENERAL RESULT" with a circular progress indicator for "45 CROPS" and a "NUTRITIONAL VALUE" table. The bottom-right screenshot is the "SIMULATION" screen showing time-series graphs for O₂ CONTENT, CO₂ CONTENT, TEMPERATURE, HUMIDITY, O₂ / CO₂ SCRUBBER ON/OFF, and N₂ CONTENT.

RESULTS

GENERAL RESULT

- GREENHOUSE: 135m²
- AEROPONICS: 238m²
- 45 CROPS

NUTRITIONAL VALUE

PROTEIN	ENERGY	TOT. FAT	IRON	VIT. B9
86%	149%	192%	333%	
POTASS.	CALCIUM	SODIUM	ZINC	VIT. E
281%	168%	1178%	169%	208%
MAGNES.	THIAMIN	OMEGA3	OMEGA6	VIT. A
638%	358%	955%	1050%	973%
NIACIN	CHOLINE	SELENIUM	FOLATE	VIT. C
190%	114%	383%	280%	1686%
CARBOHYDRATE	RIBOFLAVIN	PHOSPHORUS	VIT. K	
108%	169%	382%	4035%	



Leaving in EBIOS: learn, discover and experiment a new way of living

fully immersive experience
for scientists, astronauts and families
educational, inspiring, high-tech
helping human live in harmony with nature

**the future of regenerative living
on Earth and beyond**





EBIOS California - 2021
Mojave Desert



EBIOS Paris - 2021



EBIOS Japan - 2023



EBIOS Florida - 2022
Kennedy Space Center



EBIOS Saudi Arabia - 2022



© ALL RIGHTS RESERVED INTERSTELLAR LAB 2020



introducing
BABYDOME™





BABYDOME™

- a sealed biodome
- a subtropical greenhouse
- an aeroponic A-Frame structure
- a closed-loop water treatment system with air water catchment system
- a controlled atmospheric and air system
- a set of sensors linked our data monitoring platform and our AI prediction algorithms

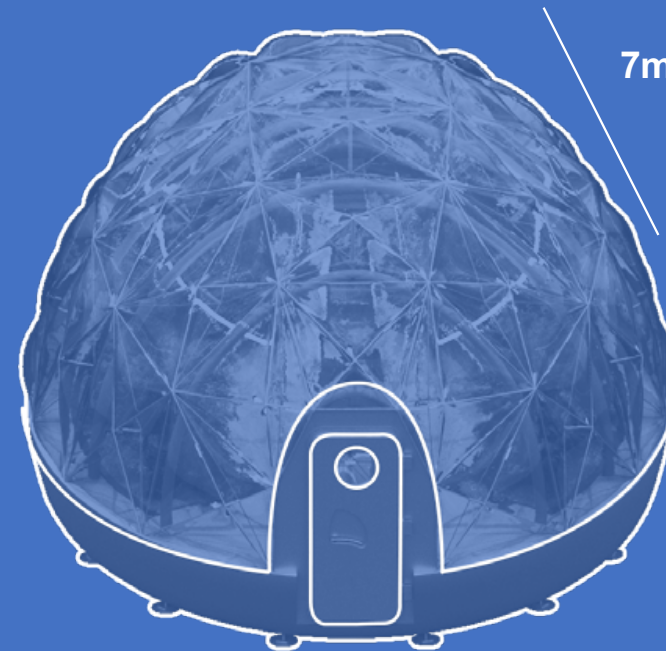

7m long

3,6m
high

5m wide



A PROTOTYPE OF A SUSTAINABLE FOOD PRODUCTION SYSTEM



Reduce land need



Reduce water need

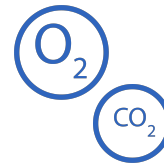

Capture CO₂



Foster Biodiversity

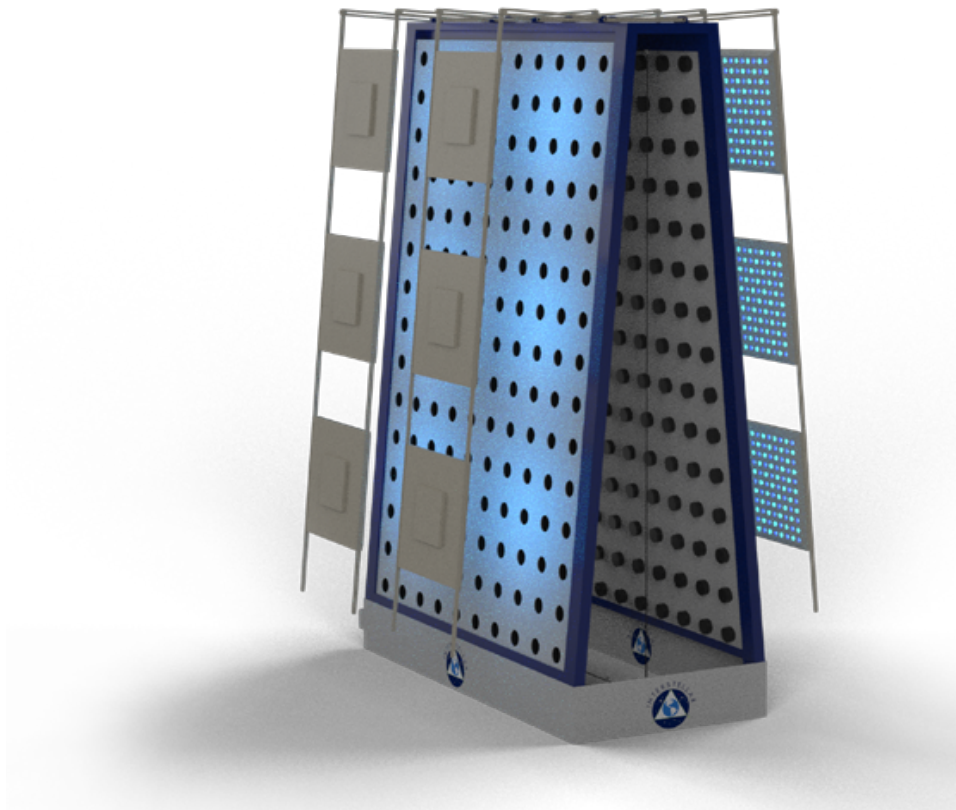

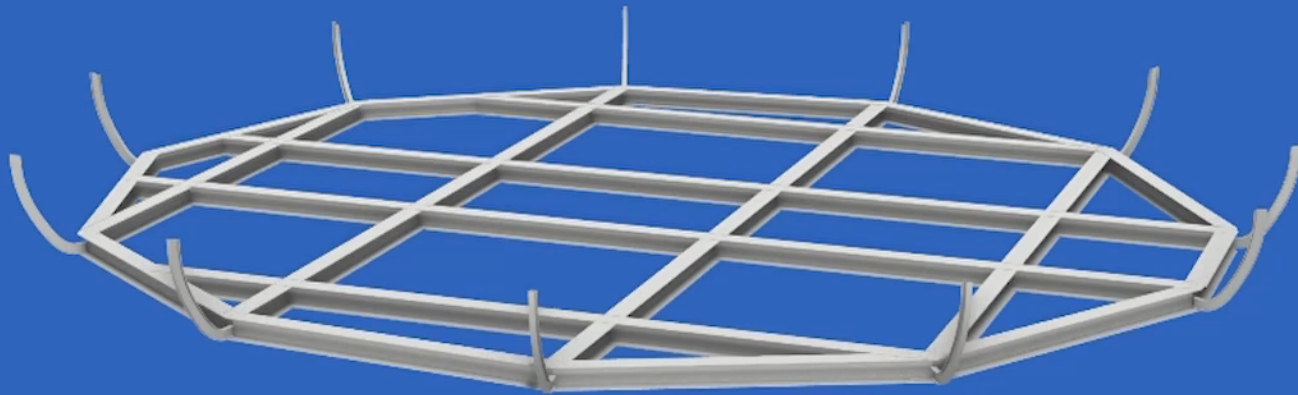

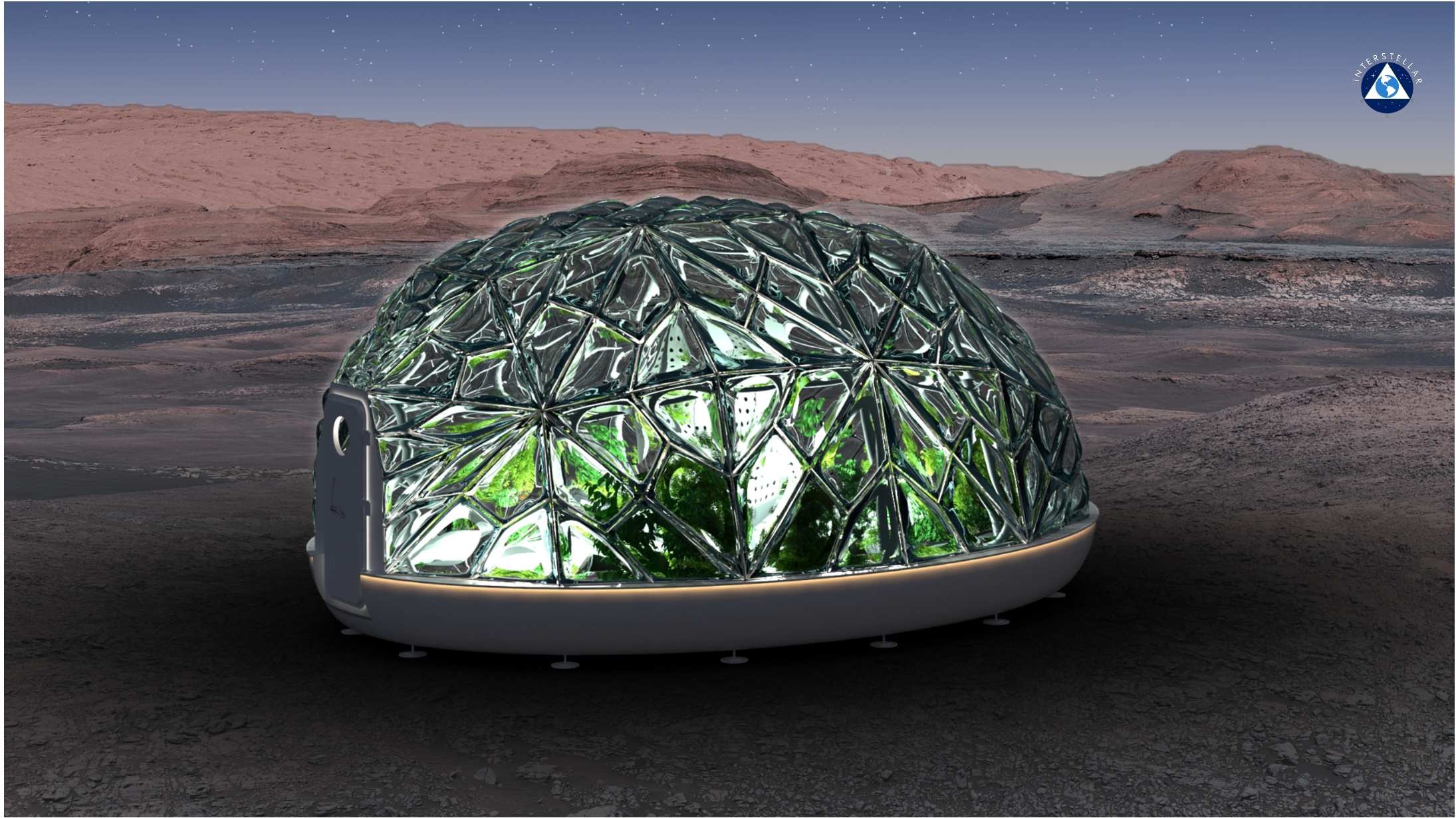





**Join us to
build a future full of life
on Earth, on Mars and beyond !**